

# Split interchangeable insert with segment ring technology

for cable sealing at the end of the duct

## WE160 SG 6x8-36

Article no.: 825817114, GTIN: 4052487164696

For installation within the KES150 MA WE sleeve to seal cables at the end of the Hateflex spiral duct 14150

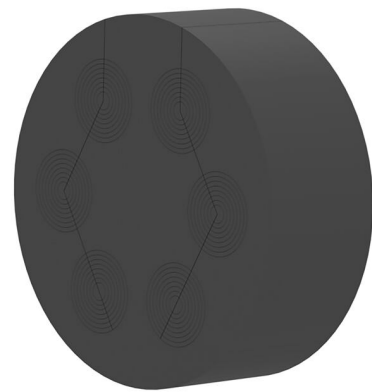

Picture may differ from selected product

## FACTS

### Advantages:

- Segmented ring technology for adjustment on-site to pipe diameters
- The interchangeable insert is installed after the cables have been laid
- The entire cross-section of the duct system is used when cables are laid

### Scope of delivery:

- Blind plugs

## Dimensions:

- OD: 160 mm
- Sealing width: 60 mm
- Maximum configuration: according to variant table

## Material:

- EPDM

## Tightness:

- gastight and watertight to 2.5 bar

# FEATURES

Number of  
cables/medium: 6

# ACCESSORIES REQUIRED



Universal Toolset