

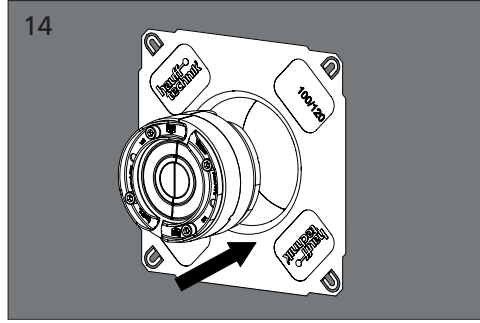

Assembly instruction - BWS Bellmouth Wall Sleeve

EN

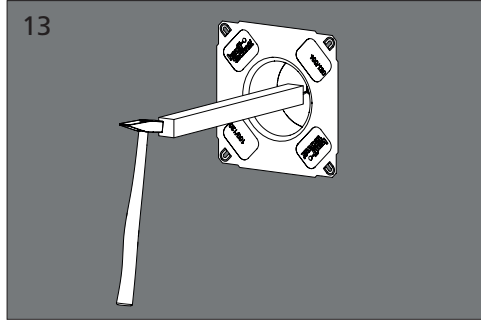
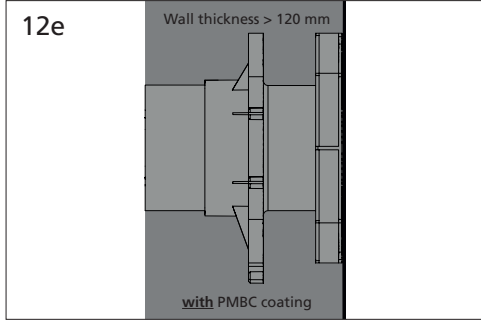
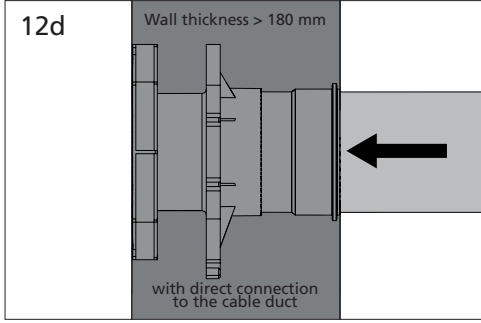
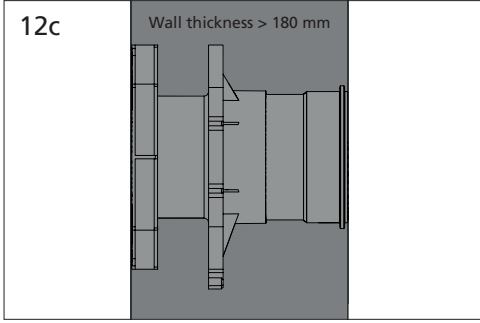
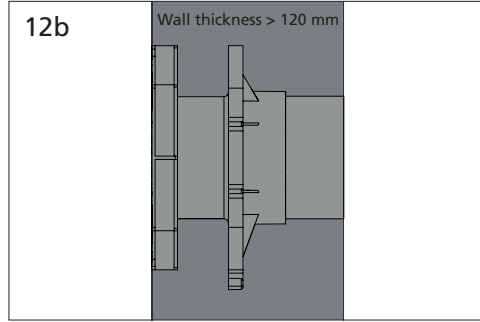
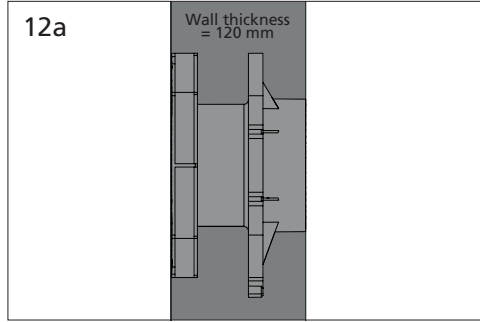
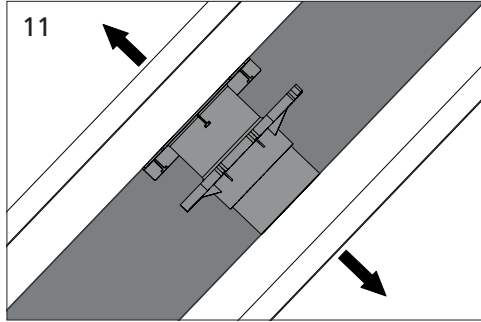
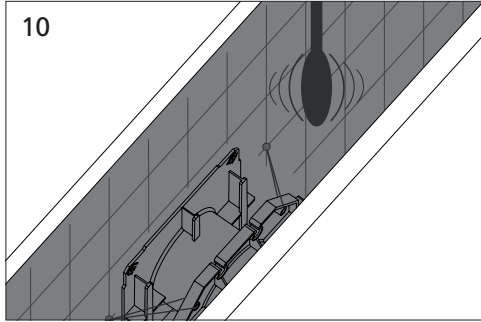
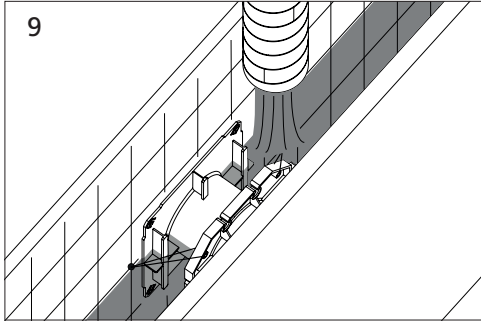
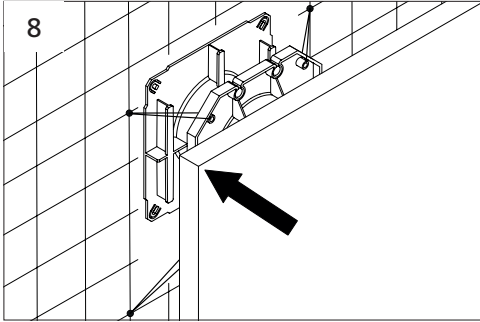
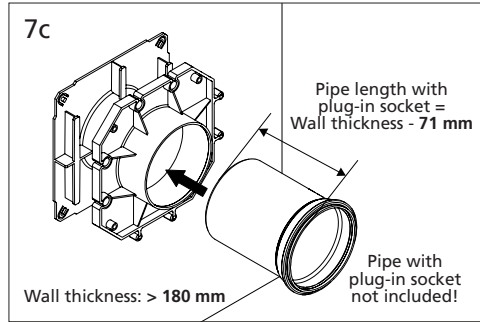
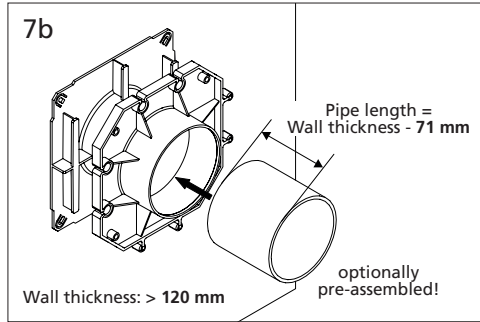
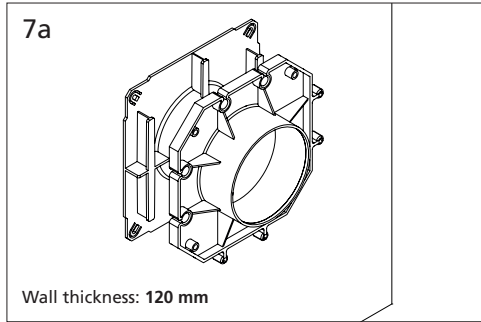
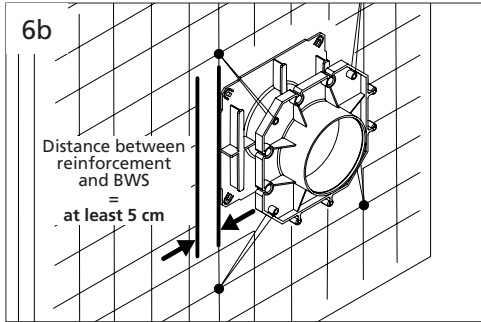
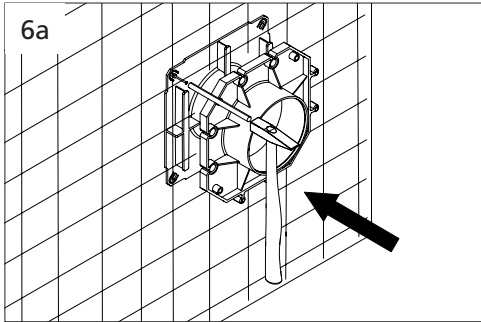
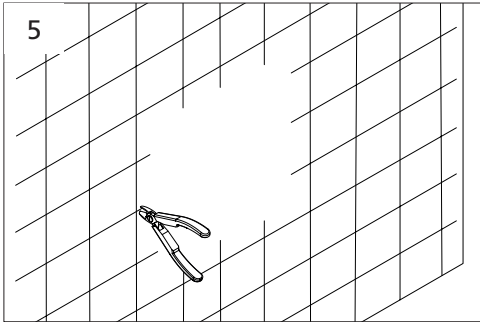
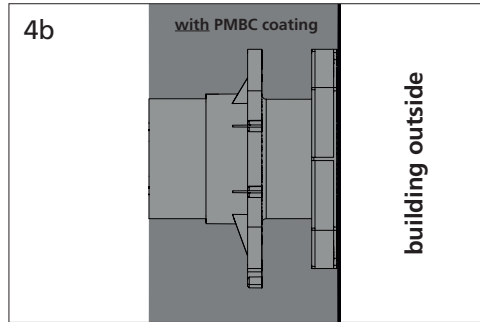
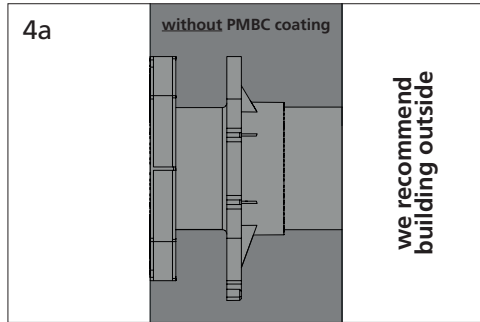
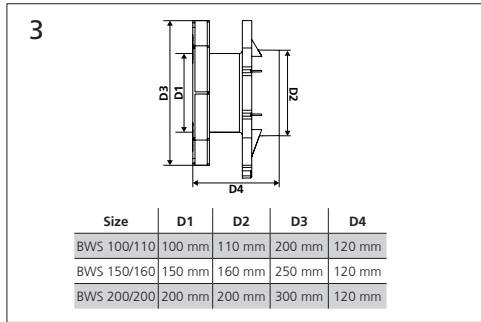
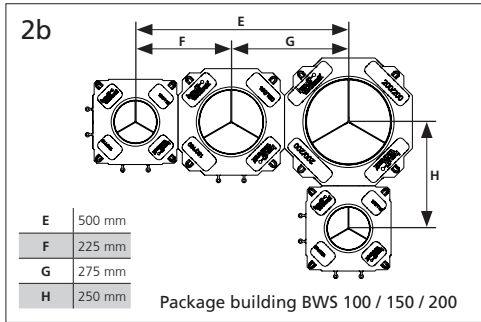
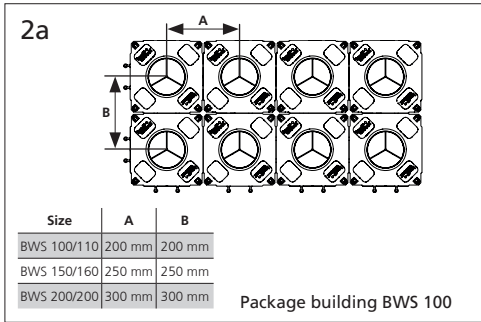
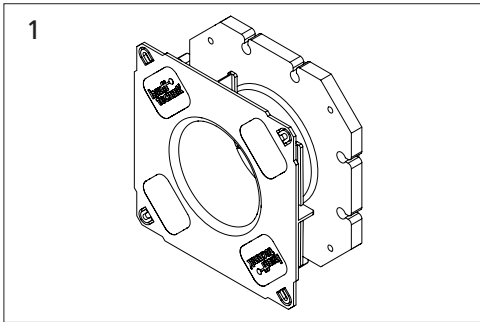

Your scan to the installation movie BWS

Safety instructions and informations

EN

Target group

The installation may only be carried out by technical experts. Qualified and trained individuals carrying out installation must have

- knowledge of general safety and accident prevention regulations as amended,
- knowledge of how to use safety equipment,
- knowledge of how to use hand tools and electric tools,
- knowledge of the relevant standards and guidelines for laying pipes/cables and for backfilling utility trenches, as amended,
- knowledge of the regulations and installation guidelines of the supply company as amended,
- knowledge of the impermeable concrete directive and building waterproofing standards as amended.

General information and intended use

According to their intended use, our products have been designed exclusively for installation in buildings made from state-of-the-art construction materials. We do not accept liability for use deviating from or beyond this unless our express written confirmation has been obtained in advance. For warranty conditions, please see our current General Terms and Delivery Conditions. The wall sleeve with cable funnel is suitable for gentle feeding of cables. Easy adaptation to the wall thickness on site by existing cable protection pipes on site. The blind plate offers a pressure tight seal after concreting. The tripartite blind plate allows easy knock in.

Safety

This section provides an overview of all the main safety aspects for optimum protection of personnel and a safe installation process. If there is a failure to observe the instructions and safety information set out here, this may result in significant hazards. The assembly must comply with the relevant professional association regulations, VDE provisions, national safety and accident prevention regulations as well as company regulations (work and procedural instructions). The fitter must wear the relevant protective clothing. Only intact components may be installed.

Required tool and auxiliaries

To install the wall sleeve BWS correctly, you will need the usual standard tools.

The following instructions are to be observed prior to installation:



WARNING! Risk of injury in the event of improper installation!

Improper installation can result in significant bodily harm and property damage.

- The nationally applicable laying and filling regulations for pipes and cables are to be observed at all times.
- Seal the underground and pipe/cable substructure well prior to laying pipes/cables so that the latter cannot subside.

! NOTE!

No sealing due to incorrect assembly!

Improper installation can result in damage.

- Paketbildung durch Rahmenstecksystem - kompatibel zwischen allen 3 Größen.
- The distance between reinforcement and the wall sleeve with cable funnel BWS must be **at least 5 cm** all around.
- The distance to component edges and other mounting parts must be **at least 15 cm**.
- The distance to building joint must be **at least 30 cm**.
- For double walls / element walls and WU concrete construction, minimum distances may be fallen below, depending on the system.
- During the process of setting in concrete, make sure compacting is carried out in layers in the vicinity of the universal wall entry. Cavities must be avoided.
- Prior to the sealing work with PMBC thick coating and the earth-side pipe connection, the integrated patch flange must be roughened with sandpaper.
- Any existing concrete remains must be completely removed.
- Wall and patch flange surfaces must be flat and without misalignment. If necessary, level the wall surface and remove any irregularities around the wall entry according to the PMBC manufacturer's instructions.
- Perform sealing work in accordance with professional and conforming to standrads.
- You must leave out the opening if you are using plastic-modified thick coatings (PMBC) and perimeter insulations.
- No cleaning agents containing solvent may be used to clean the system cover. We recommend using cable cleaner KR M.T.X.
- For details of other accessories and further information, see www.hauff-technik.de and the technical specification sheets.

Personnel requirements

Qualifications



WARNING! Risk of injury in case of inadequate qualification!

Improper handling can result in significant bodily harm and damage to property.

- Installation may only be carried out by qualified and trained individuals who have read and understood these instructions.

Skilled experts

Based on their specialist training, skills, experience and familiarity with the relevant provisions, standards and regulations, skilled experts are able to carry out the worked assigned, independently identifying and avoiding potential hazards.

Transport, packaging, scope of delivery and storage

Safety instructions in connection with transport

! NOTE!

Damage in the event of improper transport!

Significant damage can occur in the event of improper transport.

- When unloading packaging items on delivery and in the course of in-house transport, proceed with care and observe the symbols on the packaging.

Transport inspection

Inspect the delivery immediately on receipt for completeness and transport damage. In the event of transport damage being visible from the outside, proceed as follows:

- Do not accept the delivery or only do so subject to reservations.
- Make a note of the extent of damage in the transport documentation or delivery note provided by the transporter.

Il • Submit a claim for every defect as soon as it has been identified.
• Make a note of the extent of damage in the transport documentation or delivery note provided by the transporter.

Delivery scope

The scope of delivery of the wall sleeve BWS includes:
1 BWS 100 or BWS 150 or BWS 200

Storage

NOTE!

Damage due to improper storage!

Significant damage can occur in the event of improper storage.

- Before assembly, protect the product from damage, damp and soiling prior to installation. Only intact components may be installed.
- Storage must be carried out in such a way that it is not exposed to low temperatures (<5° C),

high temperatures (>30° C) or direct sunlight.

Disposal

If no return or disposal agreement has been concluded, recycle dismantled components after they have been properly dismantled:

- Metal remains are to be scrapped according to existing environmental regulations.
- Dispose of elastomer segments according to existing environmental regulations.
- Dispose of plastics according to existing environmental regulations.
- Dispose of packaging material according to existing environmental regulations.

Hauff-Technik GmbH & Co. KG

Abteilung: Technische Redaktion
Robert-Bosch-Straße 9
89568 Hermaringen, GERMANY

Tel. +49 7322 1333-0
Fax +49 7322 1333-999

office@hauff-technik.de
www.hauff-technik.de

Reproduction of these assembly instruction – even in extracts – in the form of reprint, photocopy, on electronic data media or using any other method requires our written consent. All rights reserved. Subject to technical alterations at any time and without prior announcement. These installation instructions form part of the product. Printed in the Federal Republic of Germany.